

Société de Promotion Immobilière Pour la Vente et la Location
PROJET DE CONSTRUCTION D'UN CENTRE DE VIE - MGHIRA III

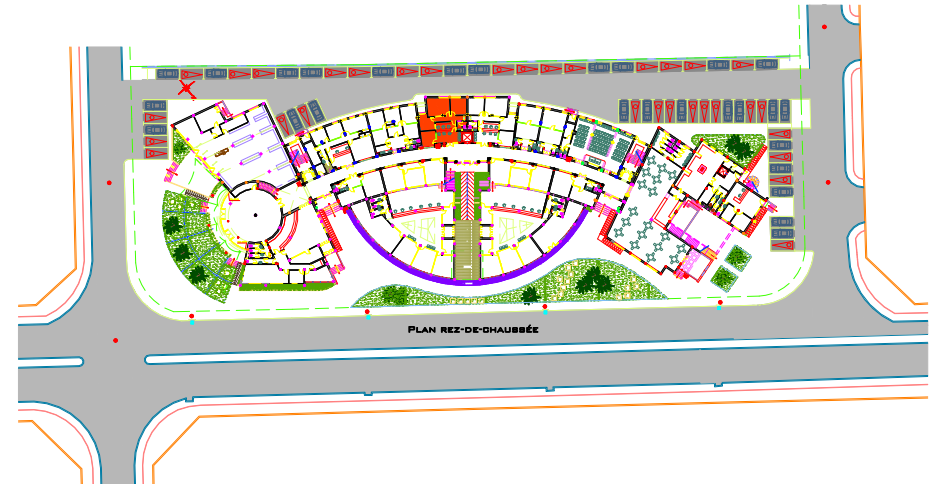
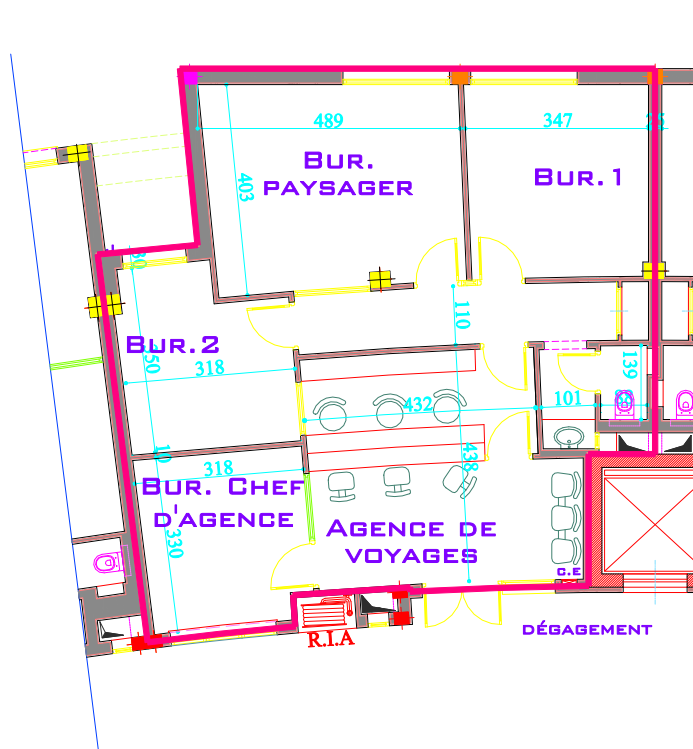
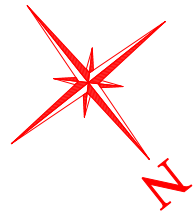

AGENCE DE VOYAGE

Niveau:	R.D.C
Surface Utile:	82,20 m ²
Surface HD :	93,22 m ²
Surface Commune:	16,87 m ²
Surf. Vendable:	110,09 m ²